

FA 25 / FAE 25

FOR COVERING JOINTS IN WALLS, CEILINGS AND FACADES – SURFACE FIXING

MIGUTEC

JOINT COVERS FOR EXPANSION JOINTS

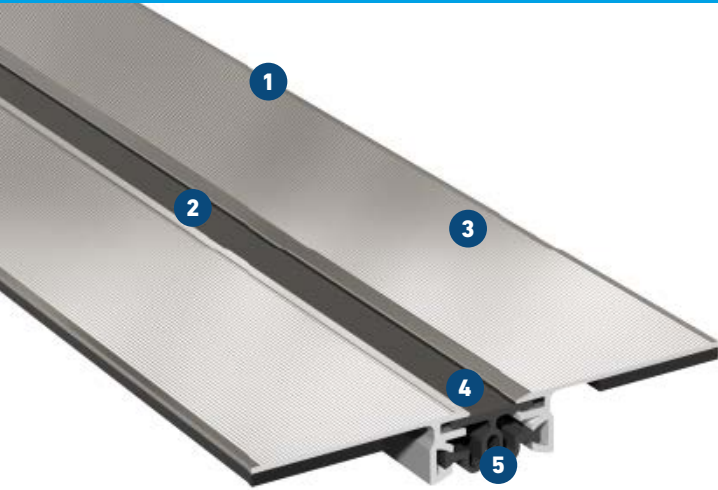

- 1 Very flat design**
- 2 Flexible high quality elastomeric insert**
Hard wearing, temperature resistant (-30°C to +120°C), replaceable
- 3 Quick and easy installation**
Aluminium brackets with cellular rubber sealing strips to compensate for unevenness in the building surface
- 4 Double protection against water**
Due to double sliding of the sealing insert within metal joint covers
- 5 Large movement capacity**
Special flexible folded insert (up to 50 m length)

Standard version	Joint width b_f max [mm]	Total movement Δb_f [mm]	Joint width total b_t [mm]	Installation height [mm]
FA 25/3	30	10 (± 5)	111	12
FA 25/5	75	40 (± 20)	157	12
FA 25/7	100	50 (± 25)	182	12
FA 25/9	150	100 (± 50)	232	12
FA 25/13	200	120 (± 60)	282	12
FA 25/14	250	180 (± 90)	332	12
FA 25/18	350	200 (± 100)	432	12

Corner version	Joint width b_f max [mm]	Total movement Δb_f [mm]	Joint width total b_t [mm]	Installation height [mm]
FAE 25/4	30	10 (± 5)	69	12
FAE 25/6	75	40 (± 20)	114	12
FAE 25/8	100	50 (± 25)	139	12
FAE 25/11	150	100 (± 50)	189	12
FAE 25/15	200	120 (± 60)	239	12
FAE 25/16	250	180 (± 90)	289	12
FAE 25/22	350	200 (± 100)	389	12

The expansion joint covers can also be supplied with holes for fixing with screws (distance 300 mm each).

Please state exact details of total joint lengths in your order. The folded insert is then supplied in one piece up to approx. 50 m for the complete joint.

Production length: 4 m

Standard colours: Grey. FA 25/3 and FAE 25/4 also available in Beige.

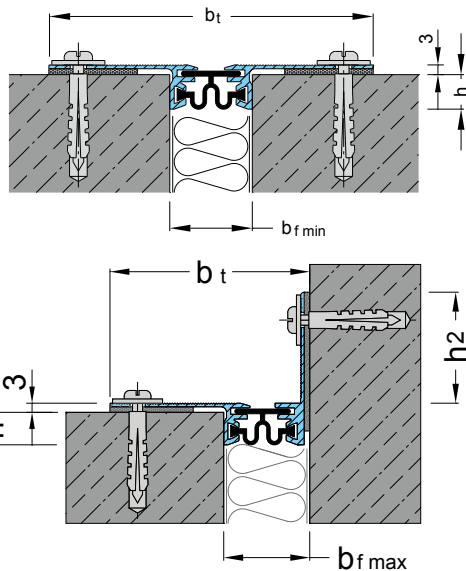

Insert for joints FA 25/3 and FAE 20/4



Insert for joints FA 25/5 and FAE 25/6



Insert for joints FA 25/7 and FAE 25/8



Insert for joints FA 25/9 and FAE 25/11



Insert for joints FA 25/13 and FAE 25/15